

Rail Kit Installation Guide

Kit Contents

(1) Rail (2 pcs)

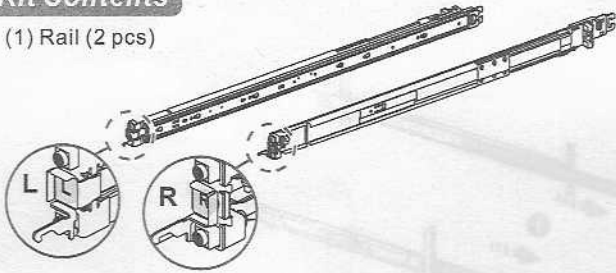

(2) Screw Sack (optional but all required for rack shipping)

⊗ M4x4L screw (2 pcs)

⊗ M5x10L-P0.8 screw (2 pcs)

⊗ Washer (2 pcs)

Caution:

The maximum supported system weight for this rail kit is 31 kg (68.3 lbs). Exceeding the rail kit's specified maximum weight limit or misalignment of the server in the rack may result in failure of the rack rails, resulting in damage to the system or personal injury.

Two people or the use of a mechanical assist tool to install and align the server into the rack is highly recommended.

Server System Installation

- (1) Remove the inner rail member of both rail assemblies as shown in figure #1. Then slide each intermediate rail member back into the rail assembly.

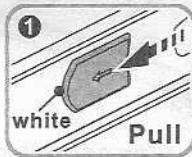

Pull tab forward and take out inner rail.

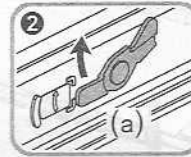

Push tab to slide the middle rail.

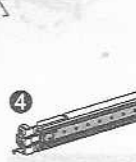
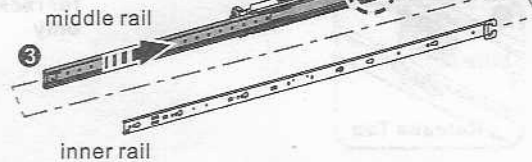
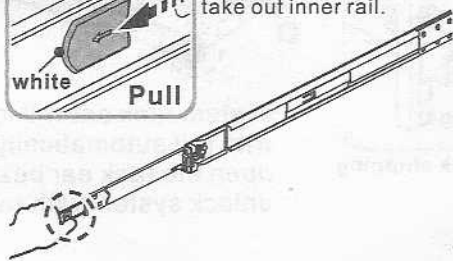

- (2) Attach the inner rail members to the system.

Intel® Server System M50CYP1UR Product Family

Intel® Server System M50CYP2UR Product Family

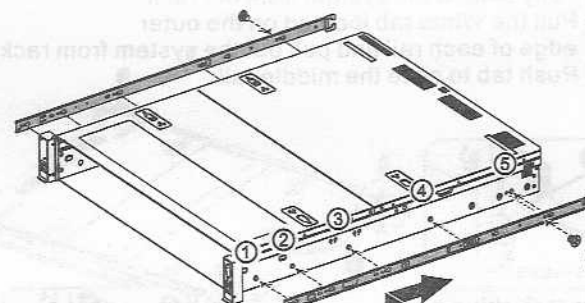
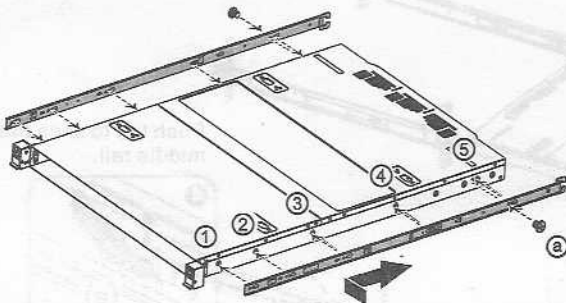

1 Key Hole ①-⑤

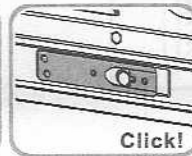
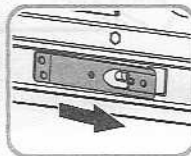
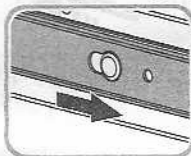

Click!

2 Screw Hole ⑥

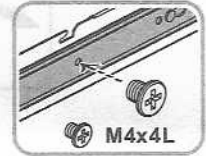

Please use 5kgf.cm torque force to fasten the screw.

M4x4L

Rail Installation

- (3) Attach the rail assemblies to the rack frame
 <1> Ensure the each rail assembly is installed level, and that each rail assembly is at the same height as the other.
 <2> Ensure that each rail is locked to the rack frame before system installation.

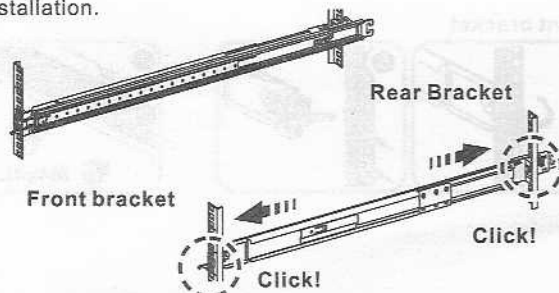

Front bracket

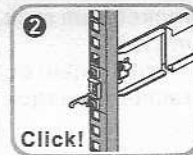
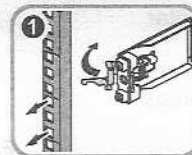

Click!

Rear Bracket

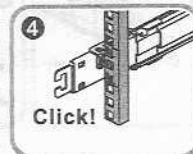
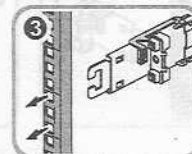

Click!

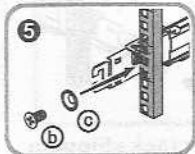

for rack shipping only

Install System into Rack

- (4) Install the system into the rails.
 - <1> Pull out the intermediate rail member until fully extended.
 - <2> Carefully align and insert the inner rail members on the system to the intermediate rail members, and horizontally push the system forward until locked.

Note: Hold the system units to push system units till engagement of 1st travel.

With over 6 kgf push force, the chassis handle might be damaged!

- <3> Slide (forward or back) the blue tab located on the outer edge of each rail, and push the system into the rack.
- <4> Secure the system to the rack using the captive screws located on each system tack handle.

CAUTION!

Ensure the ball bearing retainers is locked forward in each intermediate rail member.

Click!

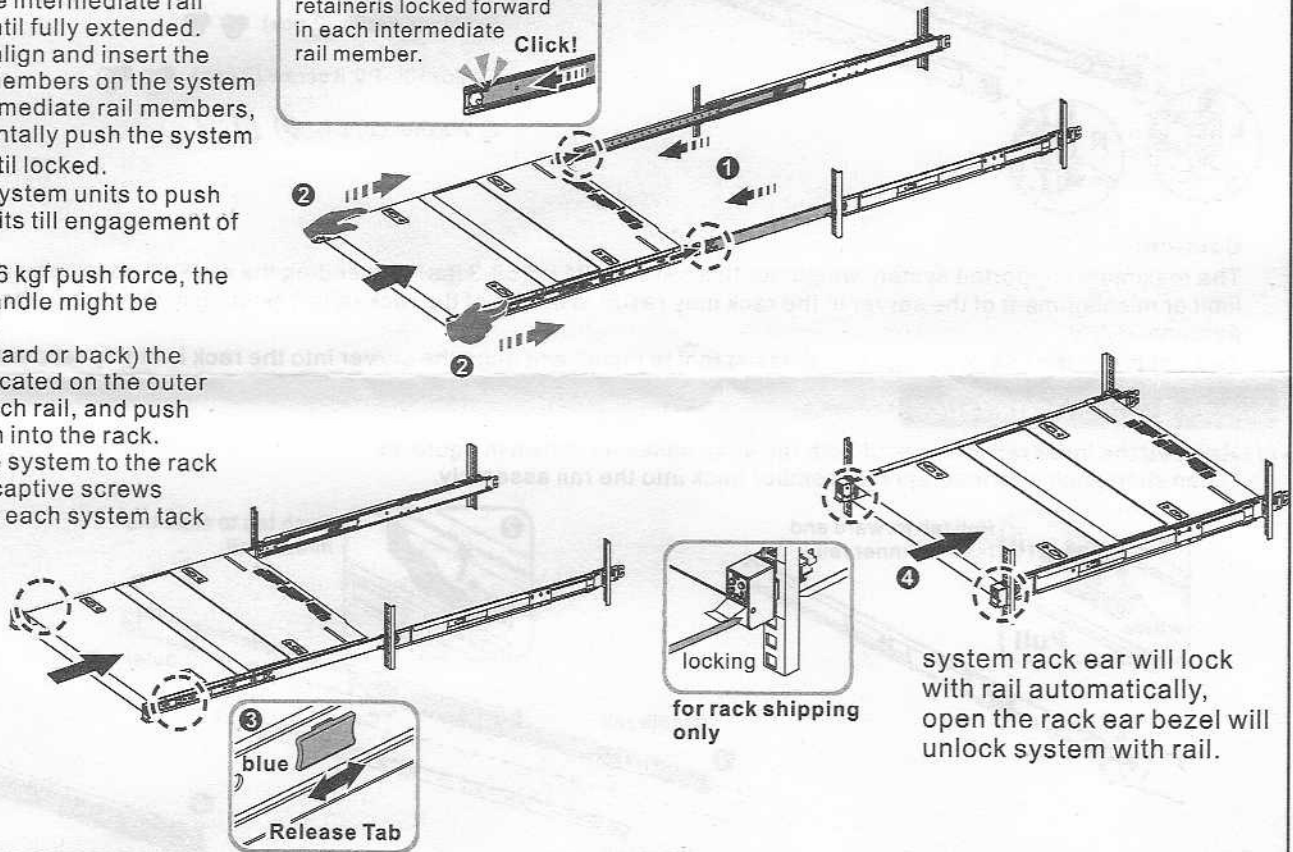

system rack ear will lock with rail automatically, open the rack ear bezel will unlock system with rail.

Removing System from Rails

- (1) If the system is secured in the rack, loosen the system handle screws and shipping screw (if present).
- (2) Fully extend the system from the rack.
- (3) Pull the White tab located on the outer edge of each rail and pull out the system from rack.
- (4) Push tab to slide the middle rail.

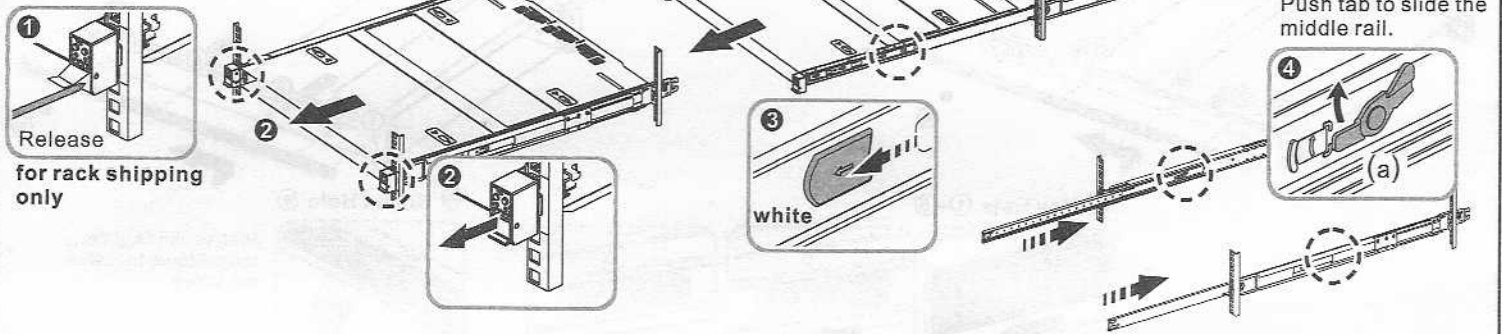

Rail Removal:

- (1) Remove server system from rails.
- (2) Push the latch on rear bracket outwards and pull out the bracket from rack pillar Space while holding rails.
- (3) Push the hook on front bracket outwards and pull out the bracket from rack pillar.

Rear Bracket

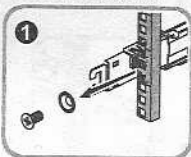

for rack shipping only

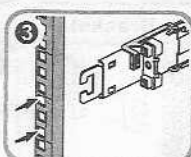
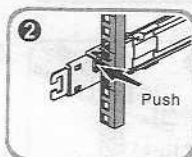

Front bracket

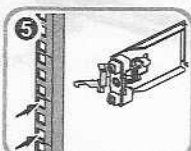
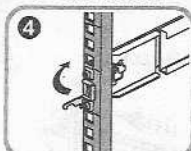

Inner Rail Removal:

- (1) Loosen the screw.
 - (2) Slightly lift up keyhole spring plate, slide inner rail forward to remove inner rail.
- ⚠ Caution, do not over bend the spring plate.

